



WCWRAIL.com

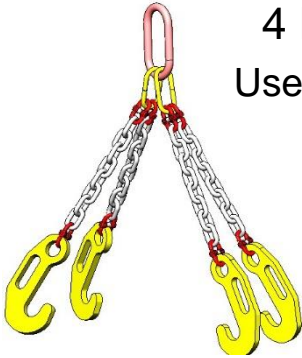


Railroad Equipment Specialists



Phone 402-253-2772 / E-mail wcw@jagwireless.net

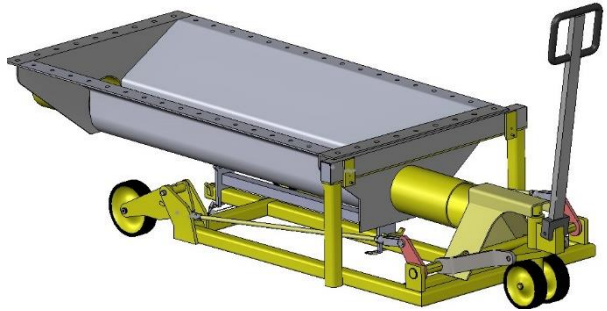
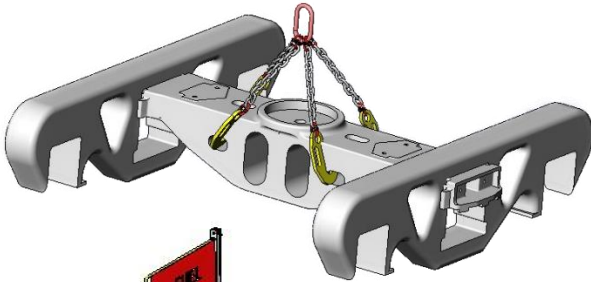
WHAT'S NEW



4 Hook Bolster Sling

Used to lift truck assembly without wheelsets.

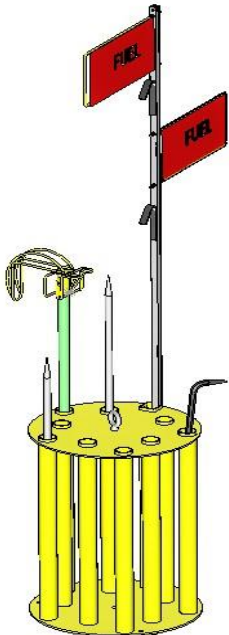
Item # 0651



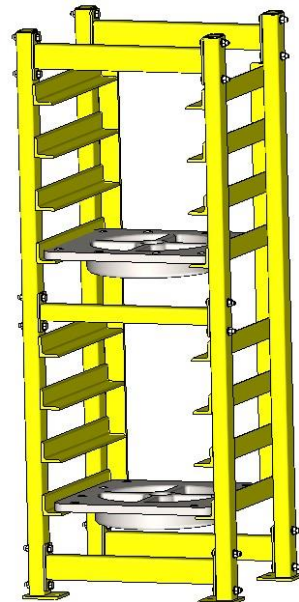
Gravity Pneumatic Hopper Gate Installation Fixture.

Item # 0264-2

(Not for use on exposed rail)



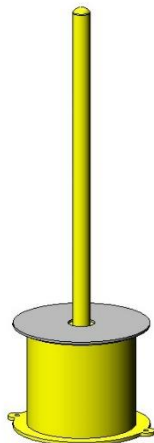
Circular Tool Storage store up to ten tools including, but not limited to; brooms, pry bars, sledgehammers, or shovels. Item # 0642



Center Plate Wear Liner Stand

This stand is designed to store all sizes of center plate wear liners. 15" diameter base X 48" height.

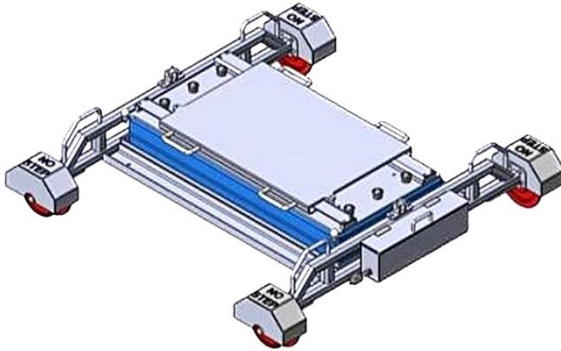
Item # 0561



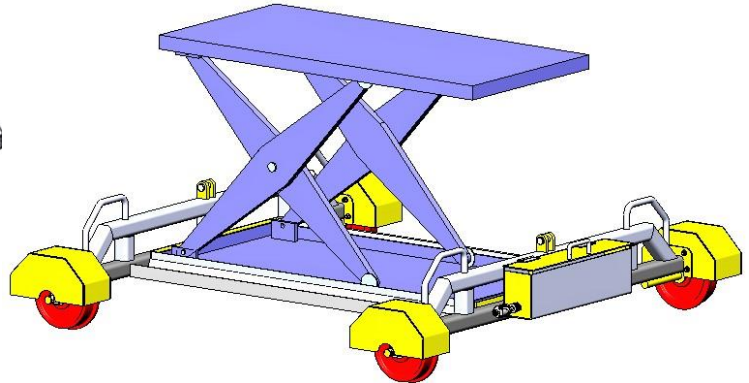
Center Plate Storage Rack Store up to 8 freight car center plates. The storage width is 21-1/2". Other widths may be constructed as necessary. Item # 0616

WHAT'S NEW

RAIL WHEELED HYDRAULIC LIFT TABLE

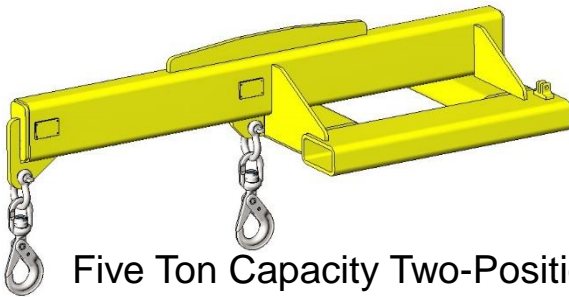


LIFT TABLE WITH BALL
TRANSFER TABLE
Item #0594-1



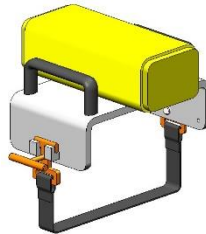
LIFT TABLE Item # 0594

Hydraulic Lift Table is used to remove and replace draft gears, end of car, or center of car cushioning devices. 3,000 lbs. capacity- 110 Volt AC. Available with a ball transfer top to provide side-to-side and back and forth positioning.



Two-Position Forklift Boom

Five Ton Capacity Two-Position Forklift Boom .Outer lift position is located 72 inches from the forklift mast, and is rated at 5,000 lbs. Inner hook position is located 36 inches from the forklift mast, and is rated at 10,000 lbs. Item # 0601



Use the new Auto-Rack Coupler To End Sill Block to maintain the proper spacing for the application of the deck bridge plates.
Item # 0604

WHAT'S NEW



The Mule

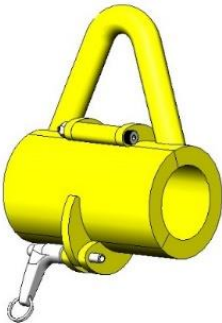
Brake Shoe Key Extractor

Designed to safely and quickly remove freight car brake shoe keys. Item # 0655
(Video at WCWRAIL.com)



15" Heavy Duty Punch With Hand Guard

- 15" long and has a 3/8" diameter tip
 - Use to remove rivets or other fasteners
- Item #: WCW-P28AHG



Locomotive Handrail Straightener

Use this new handrail straightener to straighten locomotive handrails. Pin this fixture around the bent handrail and pull on the lifting eye to straighten . Item # 0608



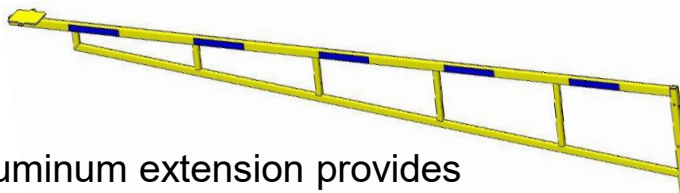
Anti-Gravity Lock Inspection Tool

For testing rotary coupler lock when inverted. Item # 0661



Handhold Straightening Tool "Tomahawk"

The 36" long knurled handle provides a slip-resistant grip and has a large head contact area for bending. Item # 0634



11' foot aluminum extension provides additional Blue Flag protection.

Attaches to manual switches. Item # 0559

WHAT'S NEW

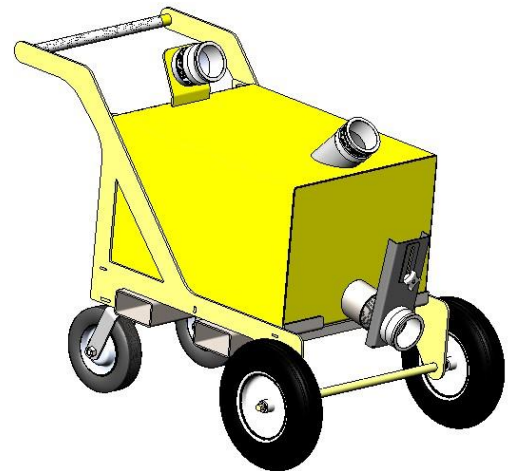


RAIL WHEELED SWIVEL WORK CHAIR

Equipped with a swivel that provides 360 degrees of rotation, and glides that allow 30" of side-to-side movement. The back rest is fully adjustable. Includes manual wheel brake and fire-resistant cushion material. Item # 0603

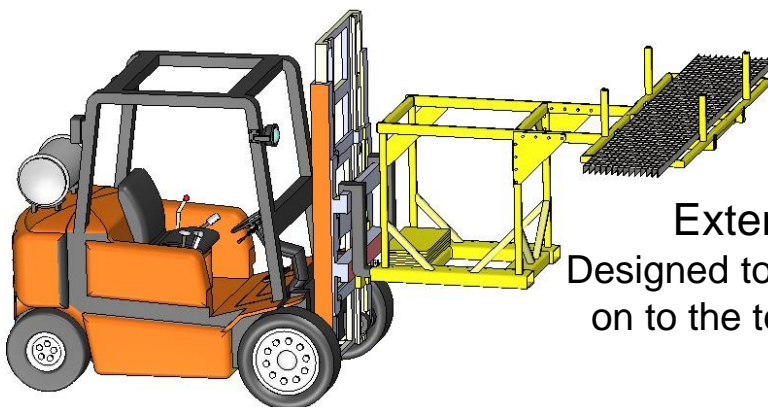
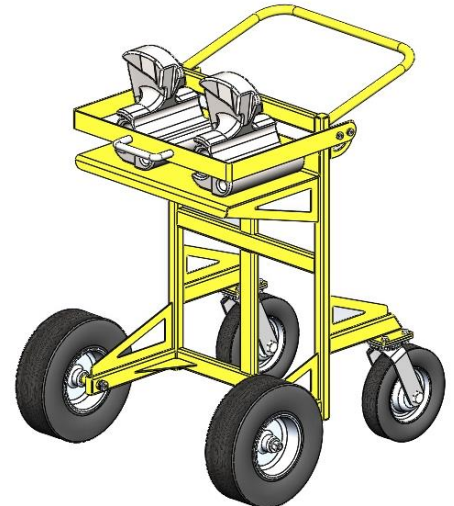
Four Wheel Toilet Servicing Cart

Dumping is accomplished by opening the locomotive style dump slide valve in the front of the cart. The tank's ball valve vent serves as a fitting to attach a water hose for clean out after dumping. Built in fork pocket adapters to transport the cart with a forklift if required. Holds 42 gallons. Item # 0632



Four Wheel Heavy Material Transport Cart

Designed to eliminate the need to tip the cart back for transport. A drop-down bail is included to keep material in place during transport. The step-in design allows the operator to get close to the cart shelf for material placement. Item # 0593

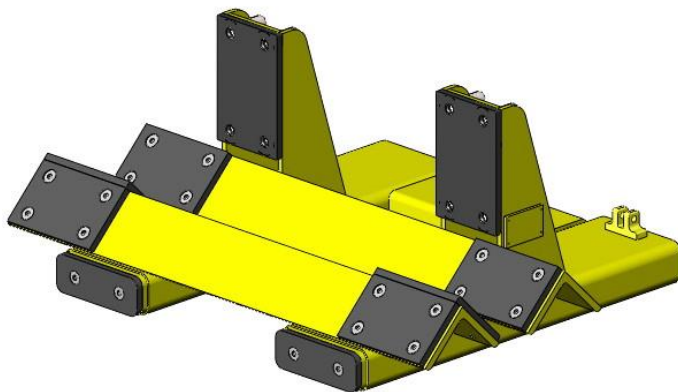


Extension Lift Fixture

Designed to help lift Running Boards on to the top of a car. Item # 0688



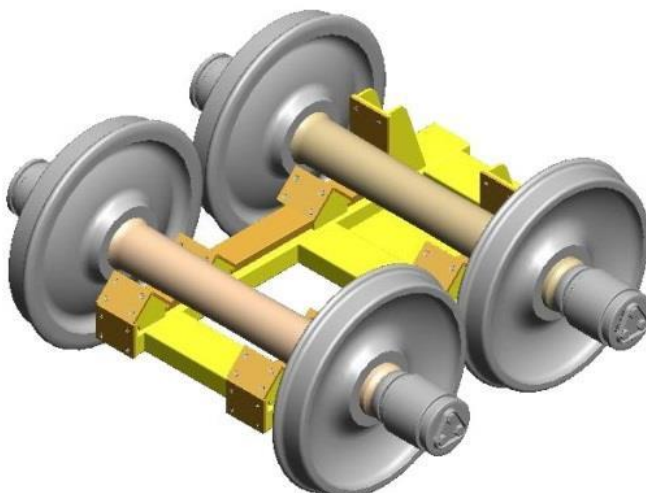
Wheel Set Handler
Item # 0161



Wheel Set
Handling Fixture
Item # 0149-1



Wheel Set Caddy
Item # 0149



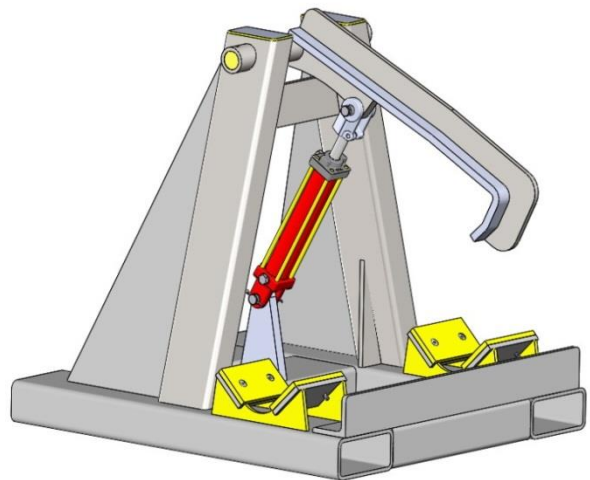
Double Wheel Set Caddy
Item # 0288



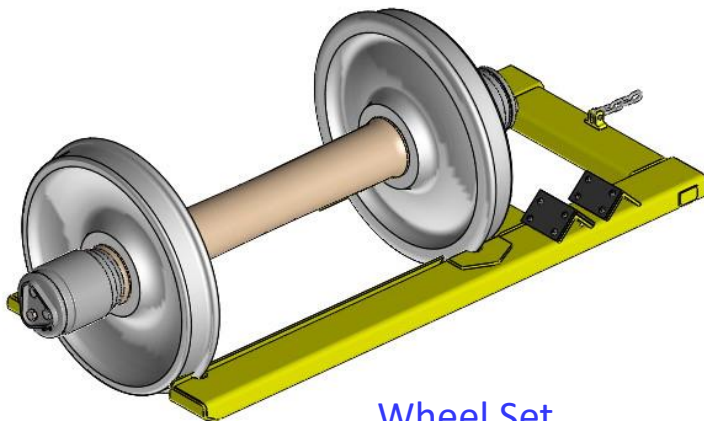
Side Access Wheel Set Fixture

Hydraulic Item # 0120

Manual Item # 0201-1

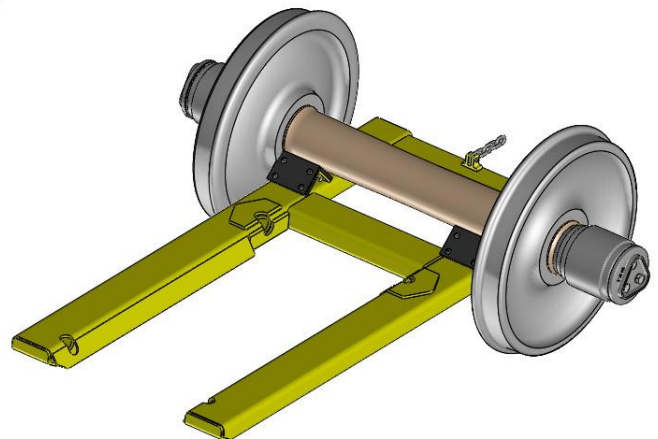


Hydraulic Model



Wheel Set Handling Fixture

Item # 0490-2





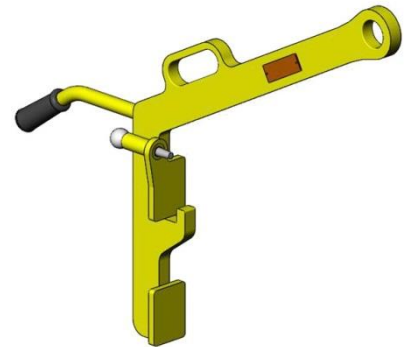
2 Tier Coupler Rack 10 Unit
 114"W X 43"D X 47"H
 Item # 0285



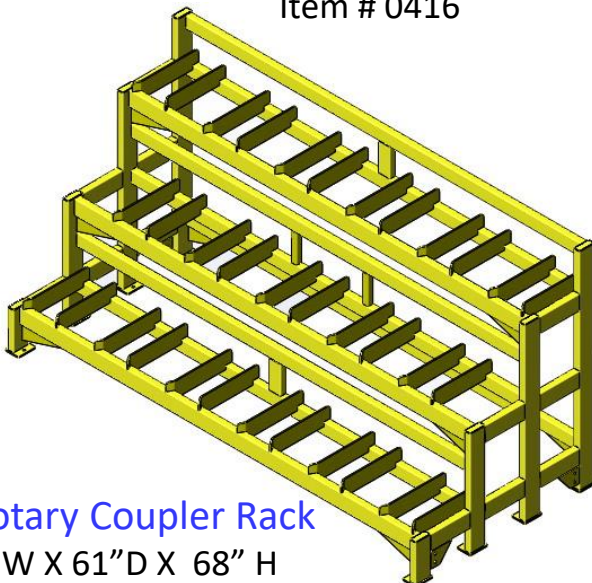
3 Tier Coupler Rack 17 Unit
 135"W X 54"D X 64"H
 Item # 0337



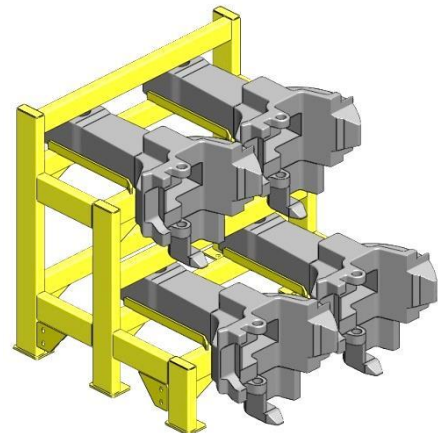
10 Unit Long Shank Coupler Rack
 113"W X 73"D X 49"H
 Item # 0416



**Long Shank
 Coupler Lifter**
 Item # 0553-1



304 Rotary Coupler Rack
 135"W X 61"D X 68" H
 Item # 0451



4 Unit Coupler Rack
 36"W X 38" D X 56"H
 Item # 0442



304 Rotary Coupler
Lifting Fixture
Item # 0405



E & F Coupler
Lifting Fixture
Item # 0168-2



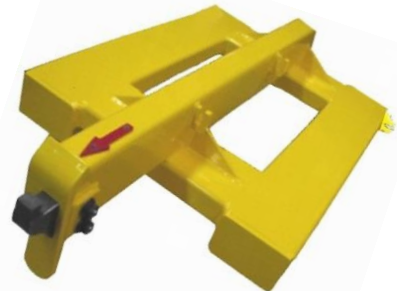
Top Shelf Coupler
Lifting Fixture
Item # 0182



Coupler Carrier
Double Tine Item # 0308
Single Tine Item # 0295



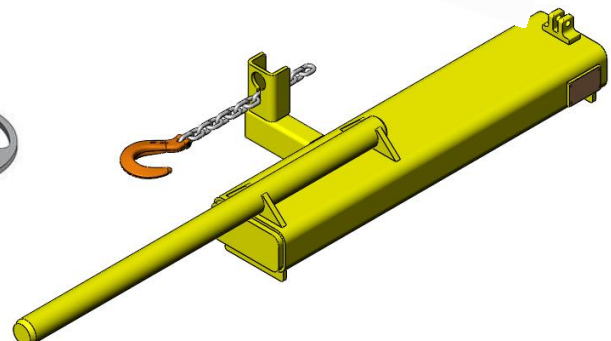
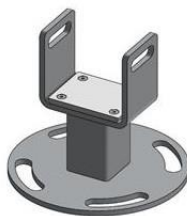
Single Tine



Double Tine



Coupler Support Fixture
Item # 0335



Bar Style Coupler Lifting Fixture
Item # 0567



Cart Mounted Hydraulic
Coupler Jack
Item # 0309



Coupler Jack
Item # 0269



Hydraulic Coupler
Lifting Jack
Item # 0297



F-Pin Lifter
Caster Base
Item # 0296



F-Pin Lifter
Aluminum Base
Item # 0294



Two Person
Knuckle Carrier
Item # 0216



Two Person Knuckle
Carrier and Installer
Item # 0287



Two-Wheel Coupler
Knuckle Cart
Item # 0259



Two Wheel Knuckle Carrier
Item # 0215



Rotating Knuckle Handler
Item # 0293



Pow'r-Riser Jacks
60 To 100 Ton Capacity



Pow'r- Riser 60 Ton
Locking U-Ring Set
Item # PRUS126



Pow'r-Riser Extension Set
Item # PRES6024



Pow'r-Riser Spacer Set
Item # PRS4
(2) 1" (1) 2" (1) 3"



Pow'r- Riser
Swivel Load Cap
Item # PRTS60



Out-Of-Level Detector
Item # 0313



Stationary Wheels

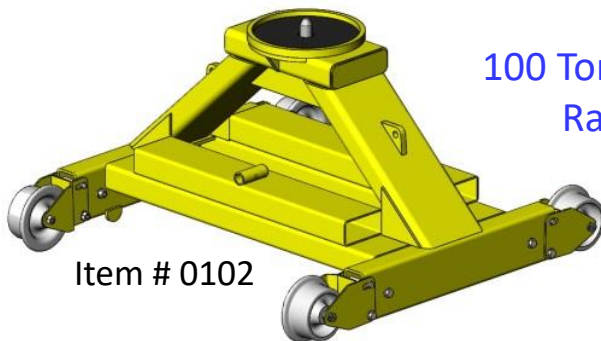


Collapsible wheels

60 Ton Side Sill Stand With Extensions For Adjustable Height

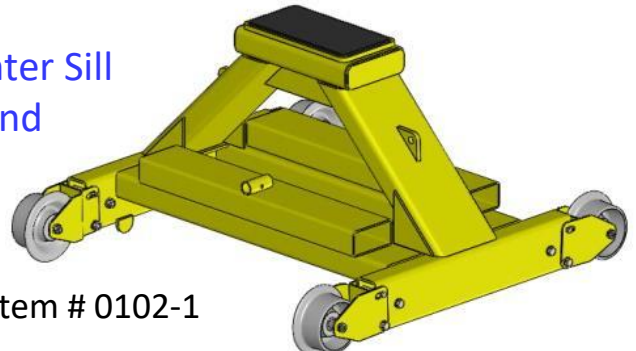
Stationary Wheels Item # 0226

Collapsible Wheels Item # 0255



Item # 0102

100 Ton Center Sill Rail Stand

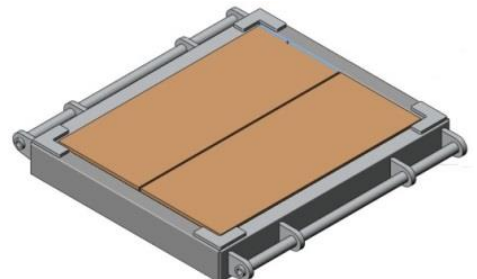
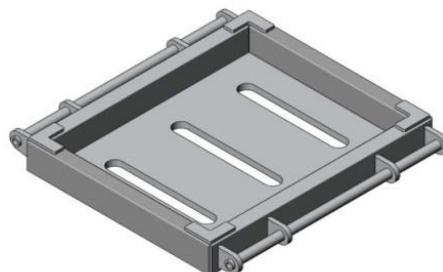


Item # 0102-1



In Floor Side Jack Extension

Item # 0458



Aluminum Jacking Pads

24" X 36" Set of 2 Item # 0407

24" X 30" Set of 2 Item # 0407-1

(Oak Blocking not Included)



Ratcheting Intermediate
Air Brake Hose Wrench

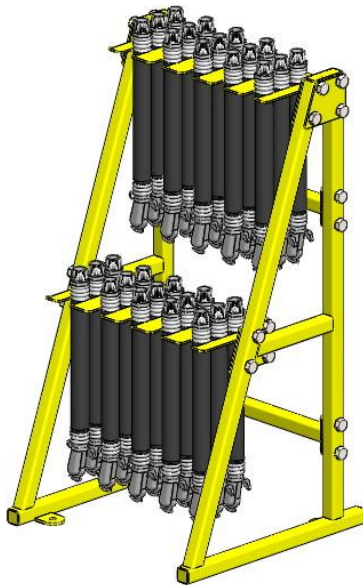
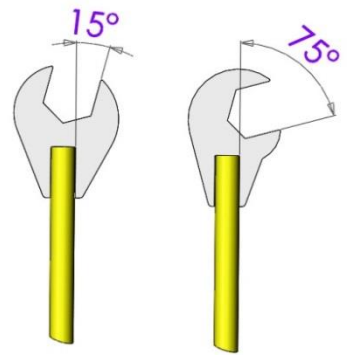
Item # 0112



Air Brake Hose Wrench

15 Degree Item # 0067

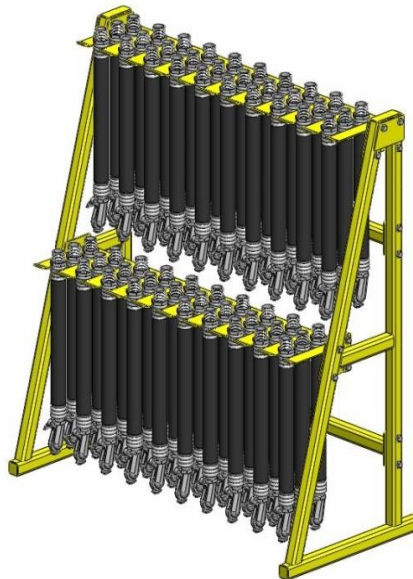
75 Degree Item # 0067-4



30 Unit Brake
Hose Storage Rack

32"W X 32"D X 56" H

Item # 0385-3



60 Unit Brake
Hose Storage Rack

61"W X 31"D X 63"H

Item # 0385



Strato Brake
Hose Storage Rack

60"W X 32"D X 63"H

Item # 0385-2



Undesired Emergency
Application Detection System

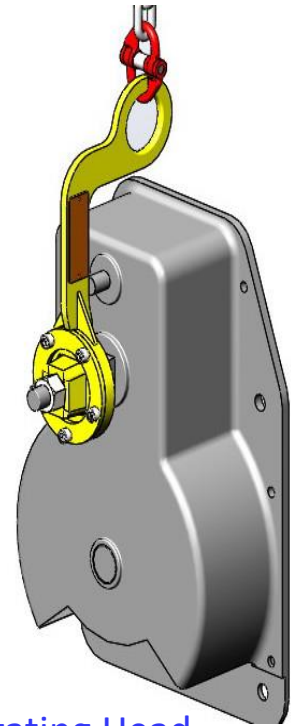
Item # 0098



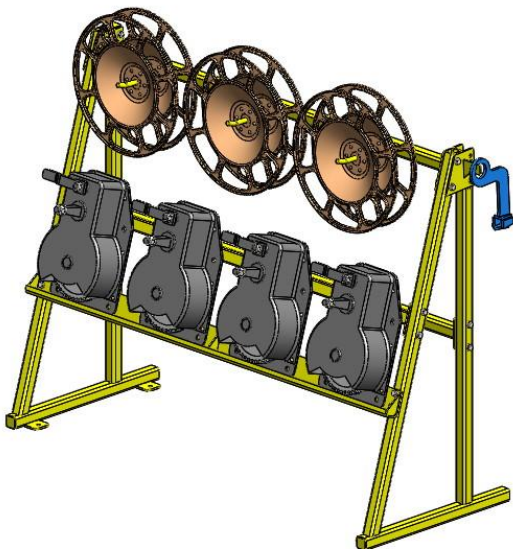
Lever Style Hand Brake
Lifting Fixture
Item # 0267



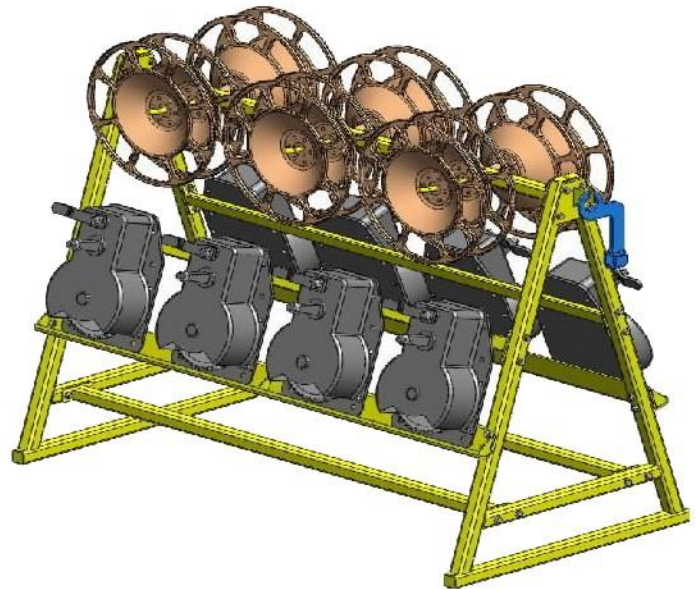
Hand Brake
Lifting Fixture
Item # 0157



Rotating Head
Hand Brake Lifting Fixture
Item # 0157-2



Single Sided Hand Brake
Equipment Storage Rack
W 77" X D 31" X H 59"
Item # 0368-1



Double Sided Hand Brake
Equipment Storage Rack
W 77" X D 41" X H 59"
Item # 0368



Universal Air Brake Tool
Item # WCW N6606



Air Brake Valve Socket
WCW N4046A



Elcon National Empty
Load Valve Test Pins
Item # 0162



Air Brake Vent Protector
Removal Tool
Item # WCWN6832B



Broken Pipe & Screw
Extractor

Complete Set Item # 0418
1-1/4" only Item # 0298



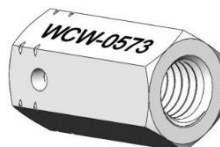
Filter Nut Socket
Item # WCWN6606-2A



Wabco Cylinder
Wrench Set
Item # 0181



Vent Protector
Plug Tool
1" NPT Item # 0336
3/8" NPT Item # 0336-1



Air Brake Valve
Stud Installation Tool
Item # 0573



Draft Gear Lifter
Item # 0247



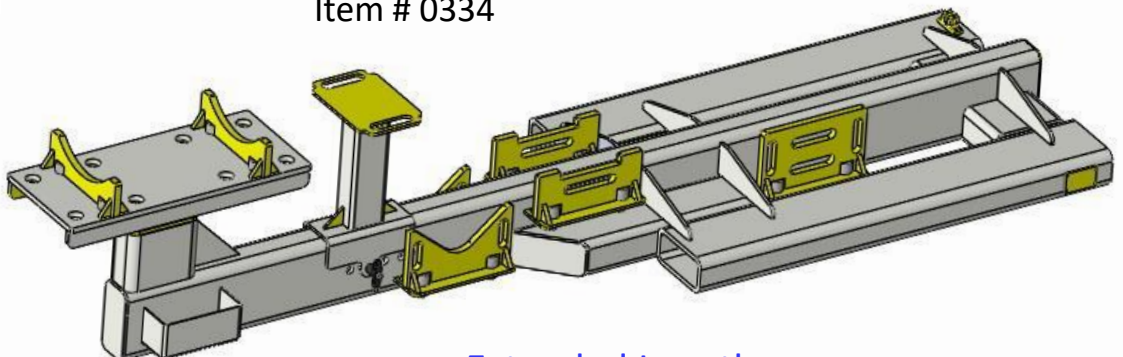
Draft Gear
Assembly Lifter
Item # 0304



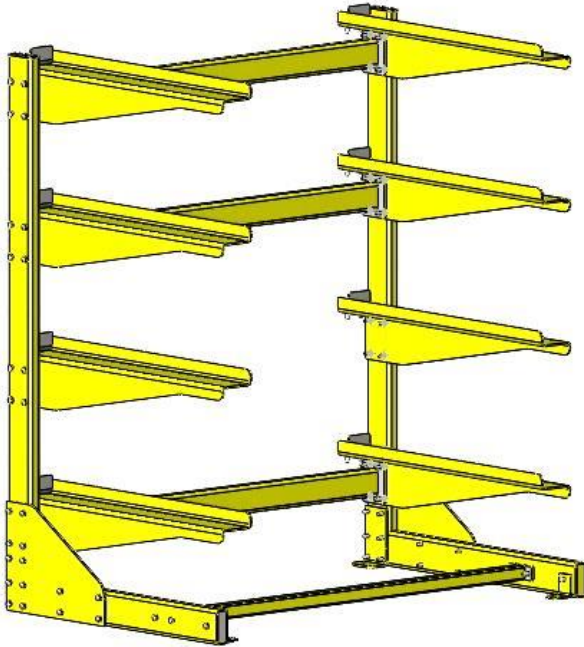
Draft Gear
Assembly Lifter
Item # 0521



Draft Gear Assembly
Installation Fixture
Item # 0334



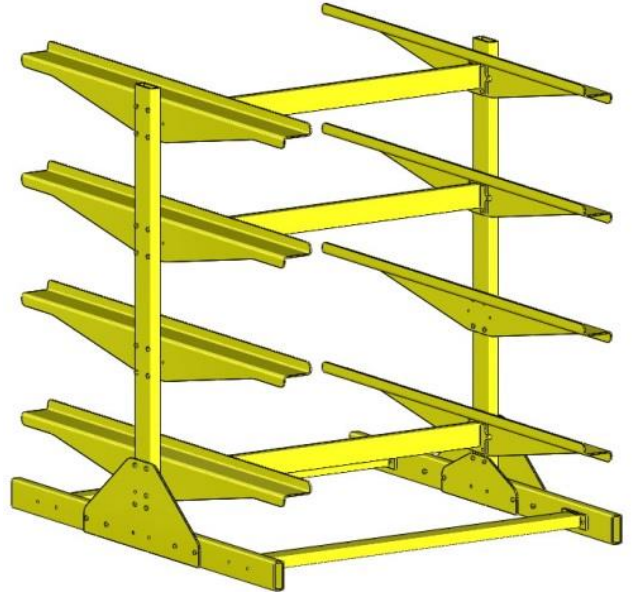
Extended Length
Draft Gear and EOC Fixture
Item # 0420



12 Unit Brake Beam Rack

70"W X 46"D X 80"H

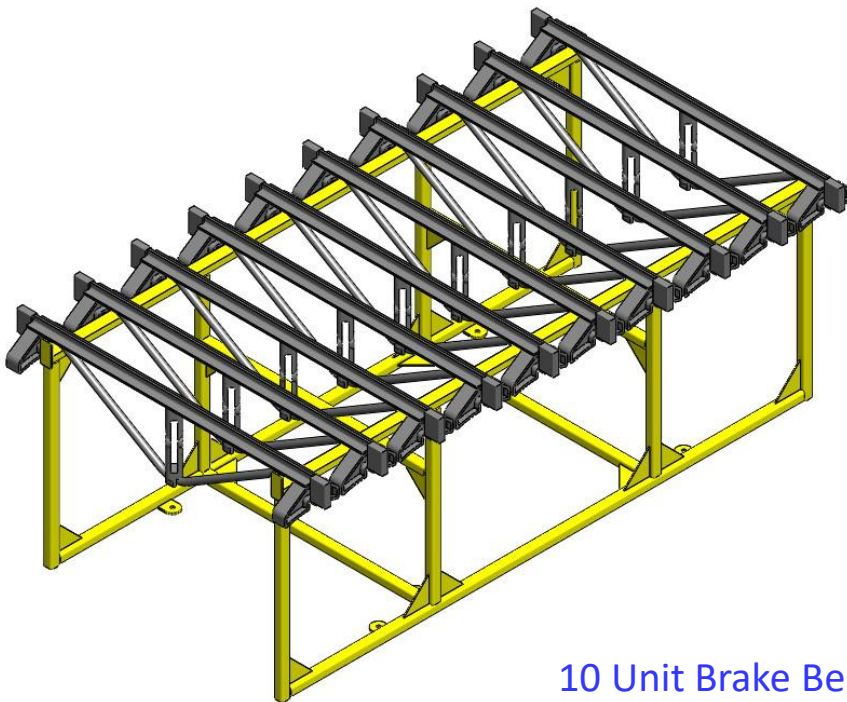
Item # 0176



24 Unit Brake Beam Rack

70"W X 80"D X 80"H

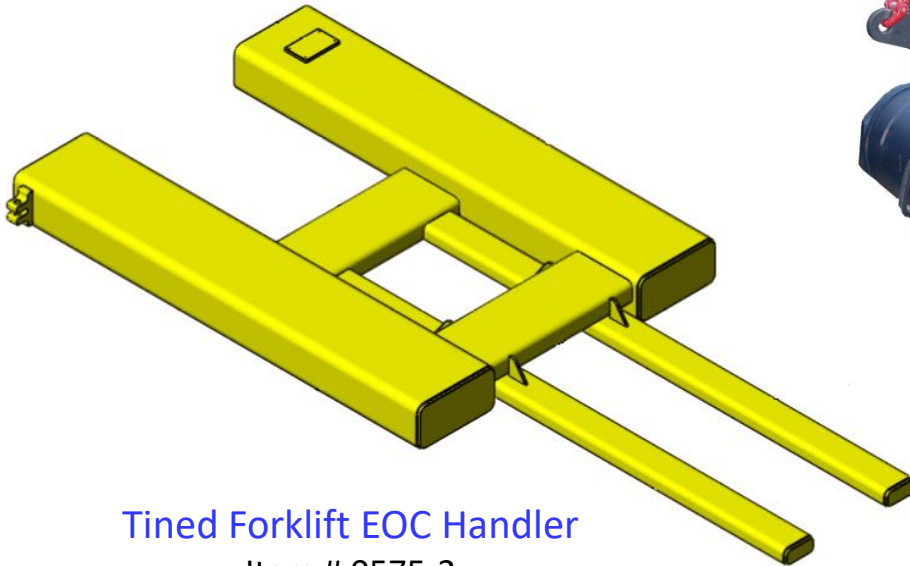
Item # 0178



10 Unit Brake Beam Rack

54"W X 120"D X 43"H

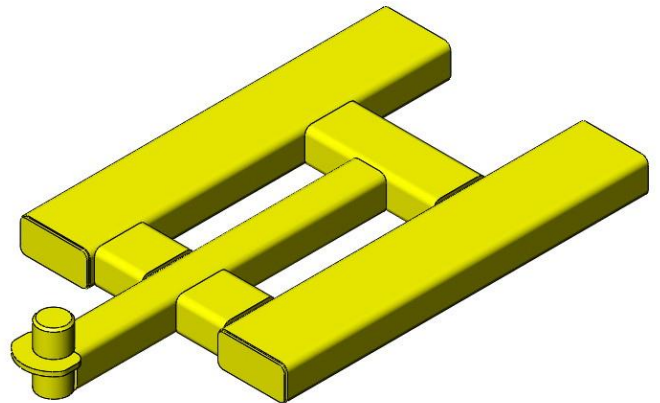
Item # 0342



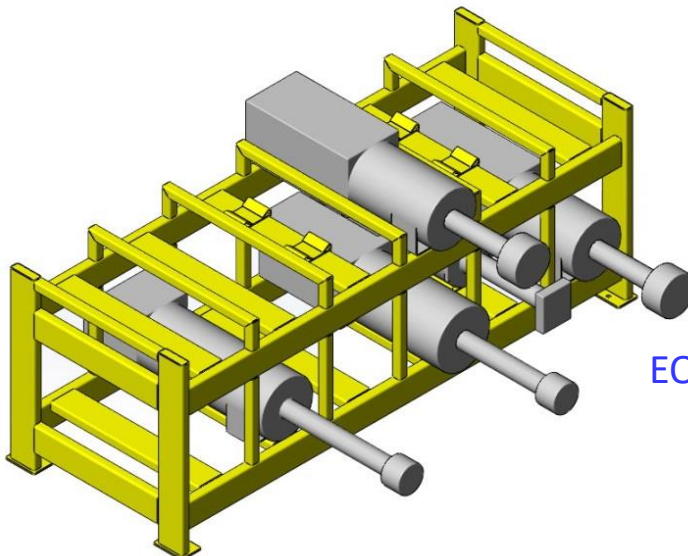
Tined Forklift EOC Handler
Item # 0575-2



EOC Lifting Fixture
Item # 0390



Pinned Forklift EOC Handler
Item # 0575-1



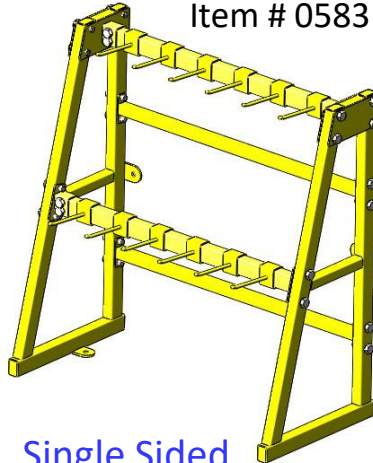
EOC Device Storage Rack
42"D X 110" W X 40"H
Item # 0575



Roller Bearing
Adapter Storage Rack

69"W X 23"D

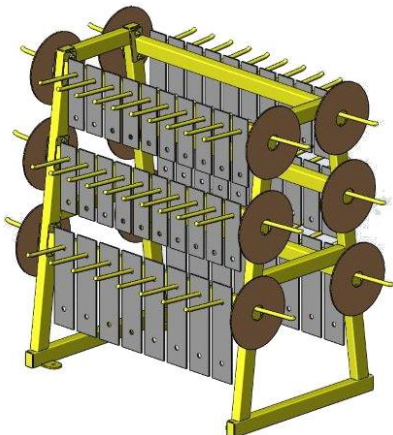
Item # 0583



Single Sided
Multi-Purpose Storage Rack

57"W X 27"D X 57"H

Item # 0312-1



Side Bearing Shim Storage Rack

62"W X 36"D X 62" H

Item # 0493



20 Unit Yoke Rack

25" W X 59"D X 67"H

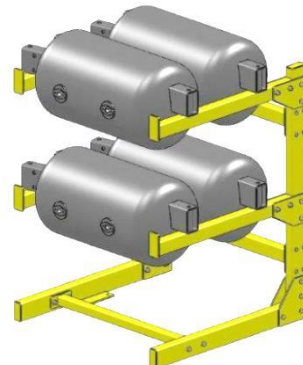
Item # 0248



Double Sided
Multi-Purpose Storage Rack

77"W X 45"D X 60"H

Item # 0312



4 Unit Air
Reservoir Rack

36" W X 38" D X 56"H

Item # 0398



Heavy Material Transport
Service Cart
25"W X 37"L X 35"H
Item # 0261-1



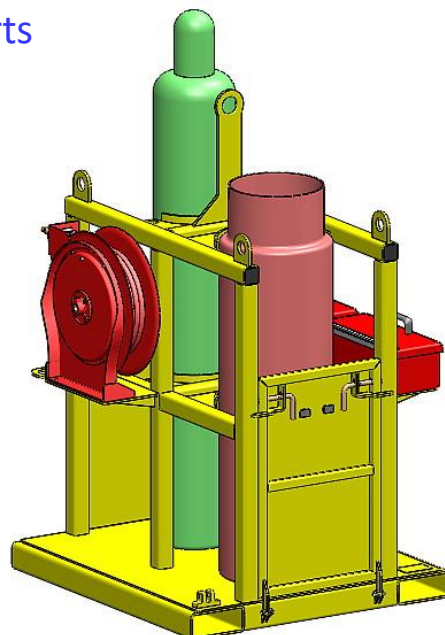
With Mounting Bracket
For Air Brake Testing Gauges
Item # 0261



Heavy Material
Service Hand Carts
Item # 0039



Heavy Material
Service Cart
24 X 24 X 32"H
Item # 0543



Forklift Torch Cart
Item # 0377



**Hydraulic
Hand Hold Straightener**

3' Long Extension Wand Item # 0199-1
 6' Long Extension Wand Item # 0199-2
 10' Long Extension Wand Item # 0199-3



**Aluminum
Hand Hold Straightener**
 Item # 0393



**Stainless Steel
Brake Stick Enclosure**
 Item # 0432

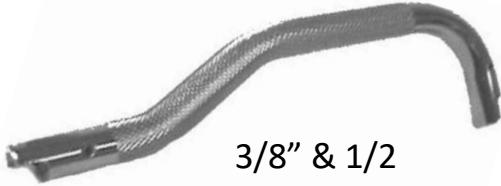


**Brake Stick
Telescopic Handle**
 24" To 42" Item # 0328
 49" To 81" Item # 0330
 67" To 104" Item # 0329

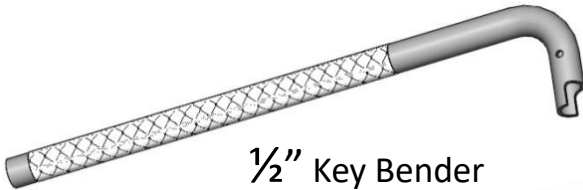
**With Magnetic
Holder**
 Item# 0328-1
 Item # 0330-1
 Item # 0329-1



Cotter Key Benders



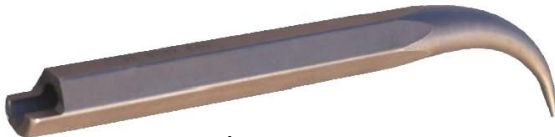
3/8" & 1/2
Combo Key Bender
Item # 0070



1/2" Key Bender
Item # 0072



3/8" Key Bender
Item # 0331



3/8" Key Bender
Item # WCW690



Universal Straightening
Tool Kit

3/8" and 5/8" Head Openings
With 36" Handle

Item # 0118



Cotter Key Knocker

12" Long With Hand Guard Item # 0299

W/O Hand Guard Item # 0299-2

24" Long With Hand Guard Item # 0299-1

W/O Hand Guard Item # 0299-3



Narrow Jaw Cotter Pin Pliers

Item # 0395



Cotter Pin Pliers

Item # WCWK2952



Air Hammer Key Knocker Kit

Item # 0383



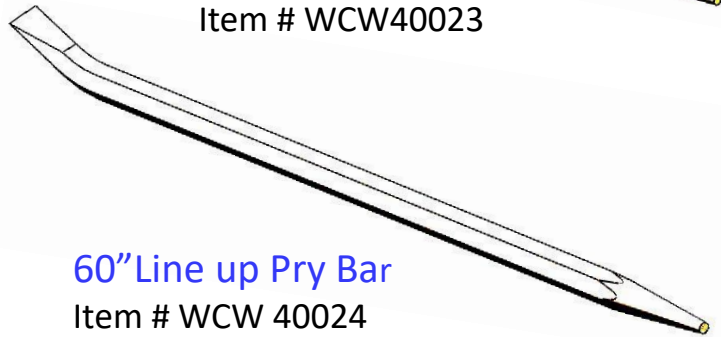
15" Drift Pin Punch

Item # 0449



42" Brake Shoe Pry Bar

Item # WCW40023



60" Line up Pry Bar

Item # WCW 40024



Drilling Hammer

Ball Peen Hammer



Mayhew

Hand Guarded Chisel

3/4" X 7" Item # WCW 85212

3/4 X 12" Item # WCW 85213

1" X 8" Item # WCW 85221

1" X 12" Item # WCW 85220

15" Heavy Duty Punch

With Hand Guard

Item # WCW-P28AHG

2 Lb. Drilling Hammer – Item # 0365

3 Lb. Drilling Hammer – Item # 0366

4 Lb. Drilling Hammer – Item # 0367

4 Lb. Long Handle Drilling Hammer – Item # 0387

1 Lb. Ball Peen Hammer – Item # 0389

2 Lb. Ball Peen Hammer – Item # 0379



Hand Guard

Replacement

Item # WCW85999



**Grey Pneumatic 1/2" Drive
Metric Standard Length
29 Pcs 12 point Duo-Socket Set**
Item # 82229M



**Grey Pneumatic 3/8" Drive SAE
Metric Standard and Deep Length
35 Pcs 6 point Duo-Socket Set**
Item # 81635MRD



**Grey Pneumatic 1/2" Drive SAE
Deep Length Duo-Socket Set
22 Pcs 6 point**
Item # 82622D



**Grey Pneumatic 1/2" Drive SAE
Standard Length Duo-Socket Set
22 Pcs 6 Point**
Item # 82622



**Grey Pneumatic 3/4" Drive
Standard Length Impact Set
29 Pcs 6 point** Item # 8029



**Grey Pneumatic 1/2" Drive
Standard Length Hex Set**
Item # 1398H



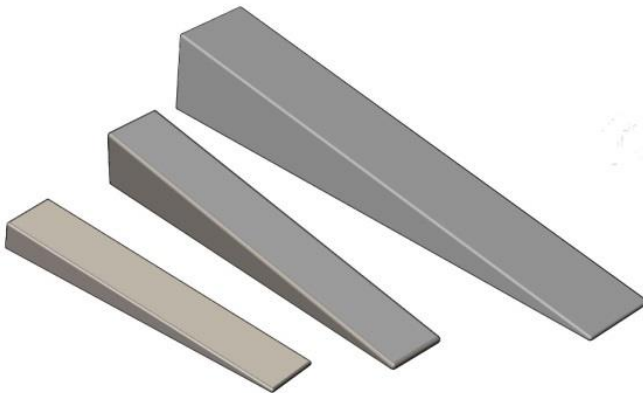
Williams 1/2" Drive
15" Long Handle 36 Tooth
Industrial Black Finish
Item # WCW52EHL



Plug Door
Roller Adjustment Wrench
Item # 0099



Carman Tool Kit
With Foam Cut Outs
Item # 0358-1



Wedge Kit Item # 0349

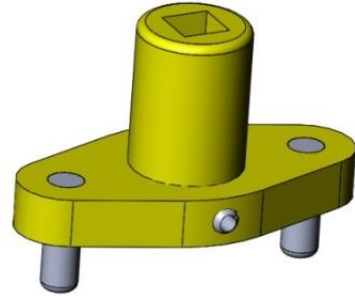
Qty.	Wide	X	Height	X	Length
1 –	2"		2"		12"
1 –	1-1/2"		1-1/2"		10"
1 –	1-1/2"		3/4"		8"



Clam Shell
Door Opener
Item # 0116



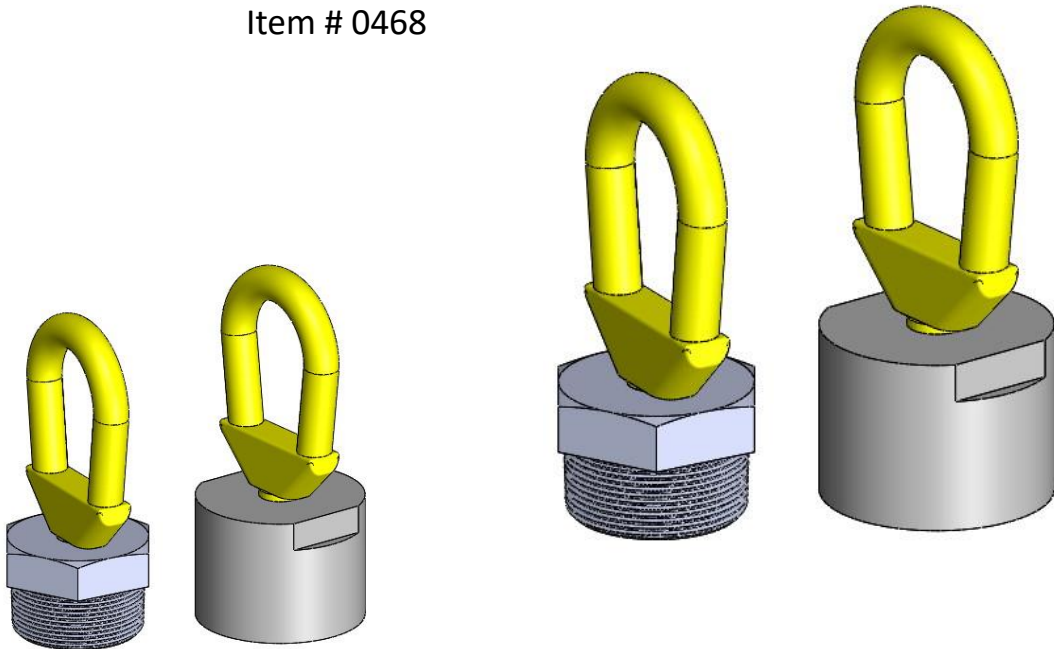
Torch Leak Tester
Item # 0278



Vertical Pin Retainer
Cap Removal Tool
Item # 0074



Wabtec ELX
Load Valve Test Pliers
Item # 0468



Tank Car Eduction
Pipe Puller (NPT Threads)

- Item # 0400 – 2" Male Pipe Puller
- Item # 0401 – 2" Female Pipe Puller
- Item # 0402 – 3" Male Pipe Puller
- Item # 0403 – 3" Female Pipe Puller



Heavy-Duty Toolbox

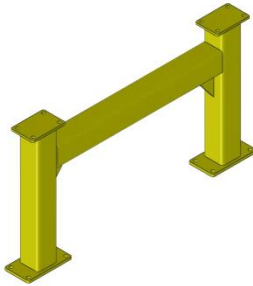
Item # 0341-1

Toolbox with Tool Shadowing Item # 0341

LED Light Item # 0341-LT

* Custom Shadowing Available

(Stand and Tools Sold Separately)



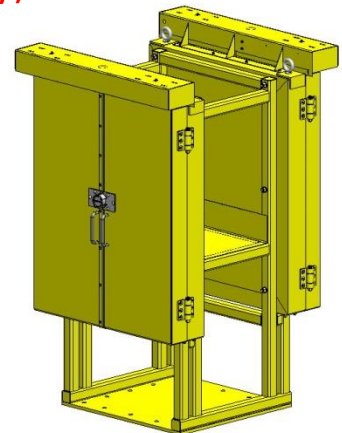
Single Mount Stand
Requires Secondary Support
From Wall or Column

Item # 0341-2



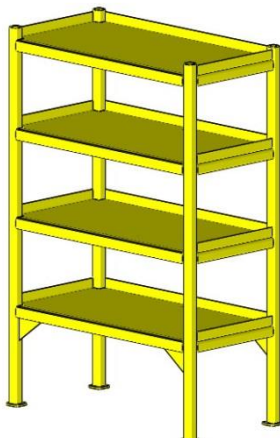
A Frame Stand

Item # 0341-4



Double Mount Stand

Item # 0341-3



Custom Built
Steel Shelving





Aluminum Draft Gear
Magnetic Pocket Gauge



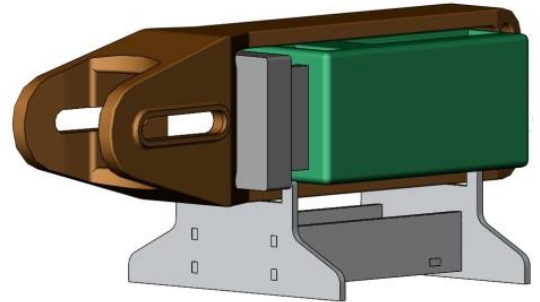
6" Wide Item # 0433-1



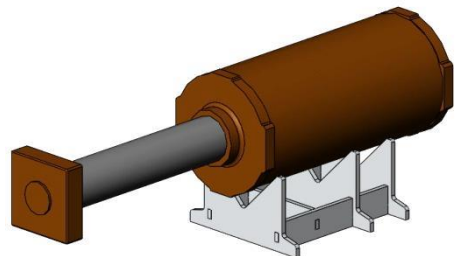
8" Wide Item # 0433



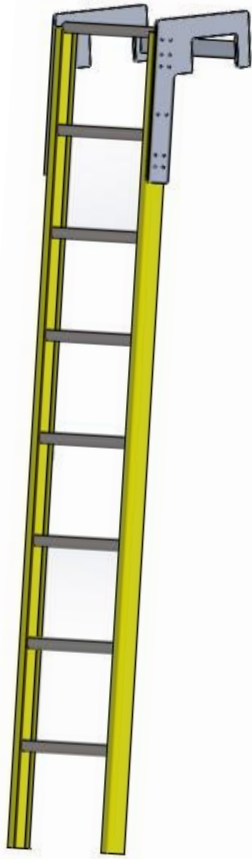
Draft Gear Assembly Table
Electric Actuation Item # 0291
Manual operated Item # 0291-1



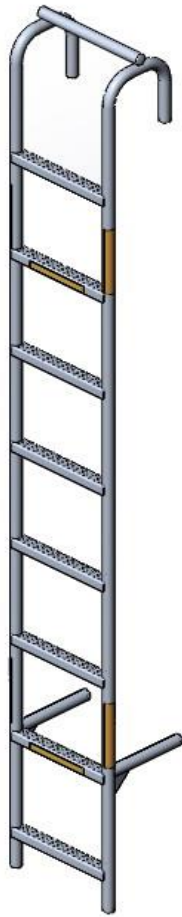
Aluminum Draft
Gear Cradle
Item # 0426



Aluminum
Round Component Cradle
Item # 0427



Coal Car Ladder
8 Foot
Item # 0115

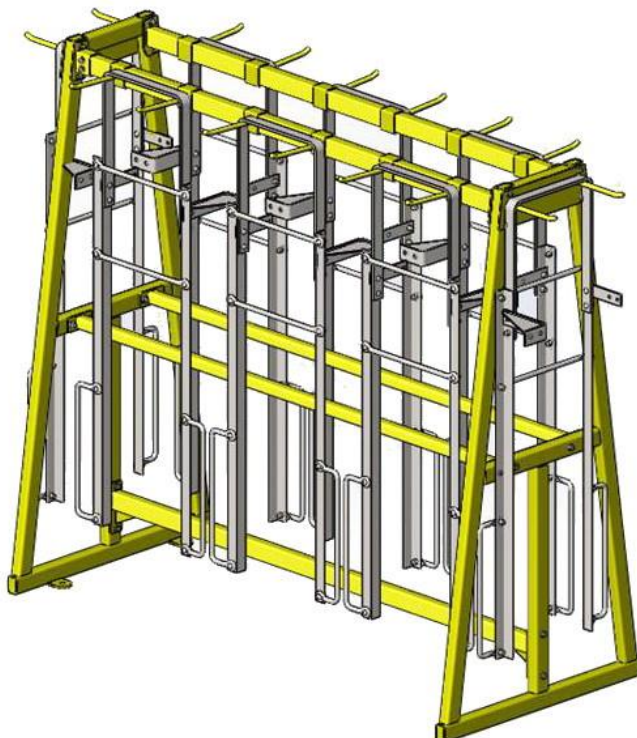


Aluminum Open Top
Freight Car
Hook Ladder

6 Foot Item # 0487
8 Foot Item # 0488
10 Foot Item # 0488-10



Aluminum Box Car
Access Platform
Item # 0359



Freight Car Ladder
Storage Rack

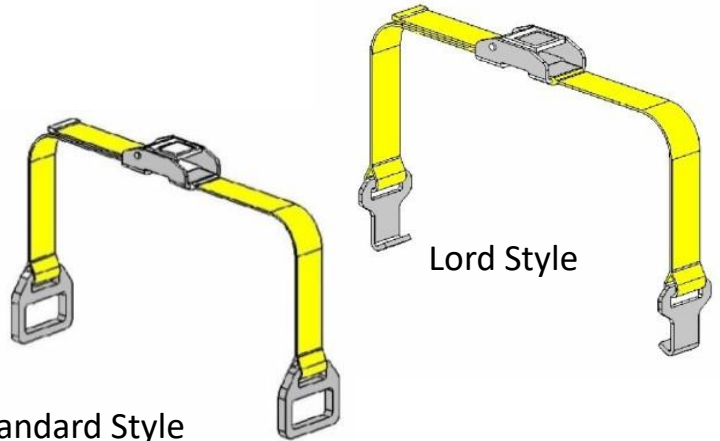
98" Long 44" Wide
Double Sided Item # 0555
Single Sided Item # 0555-1



Roller Bearing Adapter Retaining Straps

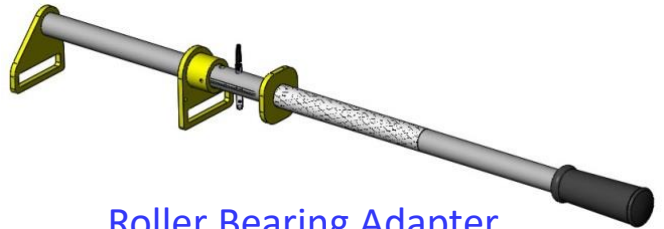
Lord Style Item # 0218
Standard Style Item # 0189

Standard Style



Cut Lever Retention Strap

Item # 0370



Roller Bearing Adapter Pick Up Tool

Item # 0284



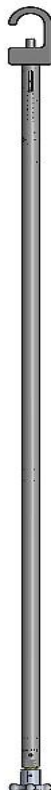
Center Pin Removal Tool

Item # 0243



Side Access Center Pin Removal Tool

Item # 0506





1-1/8" Side Bearing
Cage Wrench Set

Item # 0326



Side Bearing Lifting Tool

Item # 0532



Friction Block
Retaining Pin

Item # MLW 0137



Side Bearing Lifter

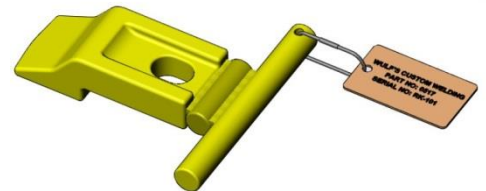
Item # 0263



Side Frame Support Fixture

26" Tall Item # 0421-1

28" Tall Item # 0421



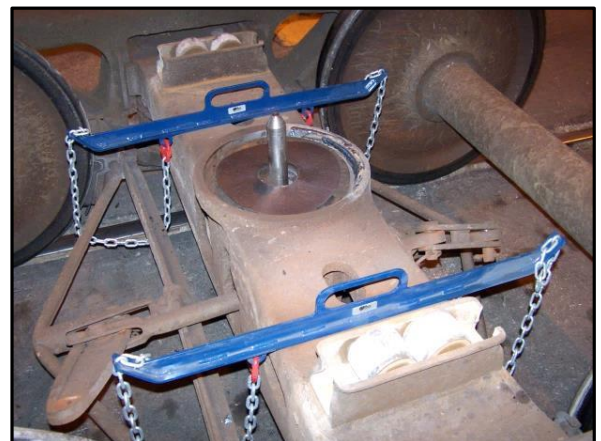
Side Frame Pedestal
Retainer Key

Item # 0517



Side Frame Lifting Fixture

Item # 0327



Brake Beam Support Fixture

Item # 0454



Bolster Lifting Sling
Item # 0262



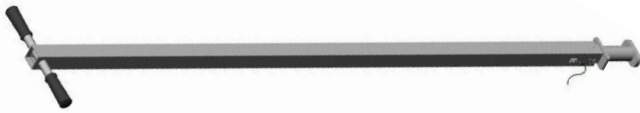
Side Frame Lifting Hooks
Item # MLW0138



Bolster Secondary Support Tool
Item # 0325



**Brake Rod
Support Fixture**
Item # 0048



Aluminum Push-Pull Truck Mover

Item # 0496



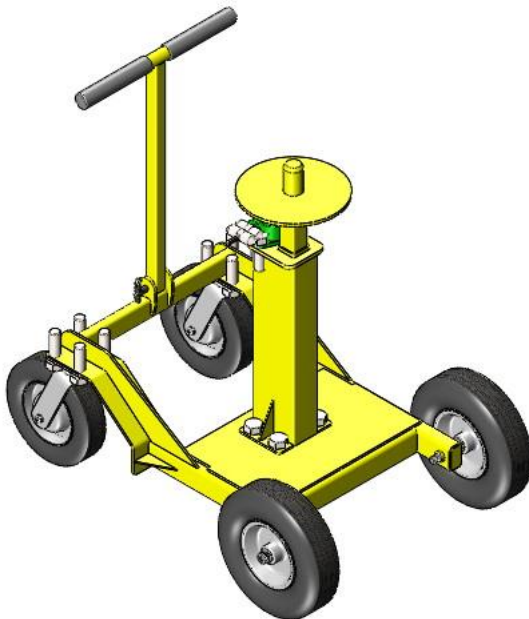
Freight Car Truck Removal and Installation Fixture

Item # 0232



Remote Side Bearing Height Gage

Item # 0249



Center Plate Installation Cart

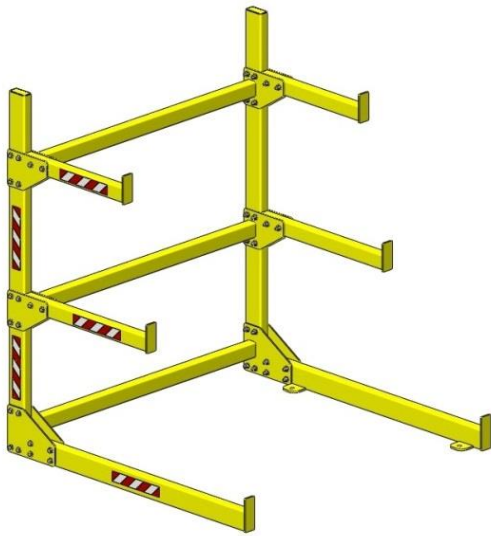
Exposed Rail Item # 0544

Flush Rail Item # 0544-1



Empty Car Truck Spring Replacement Fixture

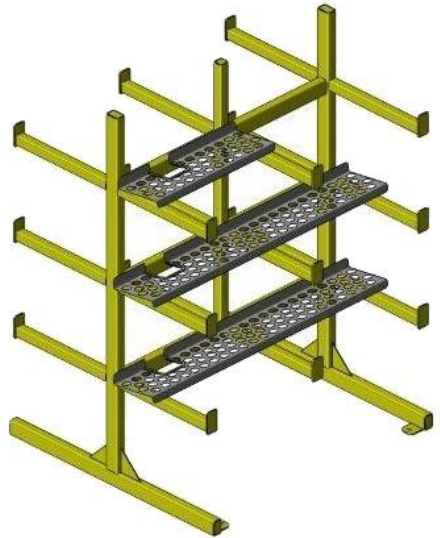
Item # 0041



Long Running Board Rack

W64" X D57" X H69"

Item # 0430



Cross Over Step Rack

W56" X D53" X H77"

Item # 0399



Uncoupling Lever Racks

Double Sided

W35" X D77" X H63" Item # 0223

Single Sided

W35" X D44" X H63" Item # 0222



With Shelf

W/O Shelf

Slack Adjuster

Banding Rack

W56" X D51" X H48"

With Top Shelf Item # 0443

W/O Top Shelf Item # 0443-1



**Slack Adjuster
Transport Basket**

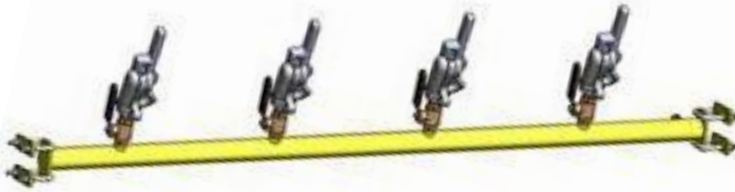
W91" X D28" X H19"

Item # 0585

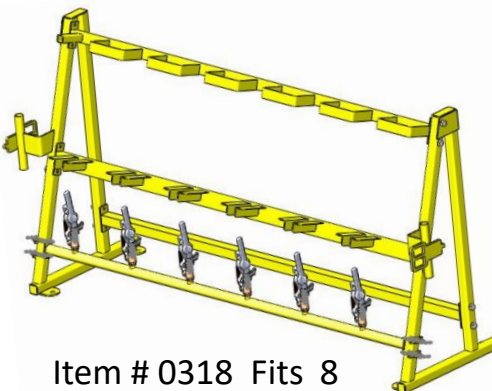


EOTD Rack

- 4 Unit Wall Mount Item # 0240
- 4 Unit Free Standing Item # 0239
- 6 Unit Wall Mount Item # 0192
- 6 Unit Free Standing Item # 0193
- 8 Unit Wall Mount Item # 0194
- 8 Unit Free Standing Item # 0195
- 16 unit Double Sided Free Standing Item # 0196



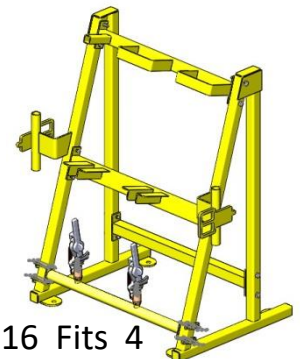
EOTD Storage Rack Charging Bars



Item # 0318 Fits 8
Unit Rack With
6 Air Outlets



Item # 0317 Fits 6
Unit Rack With
4 Air Outlets



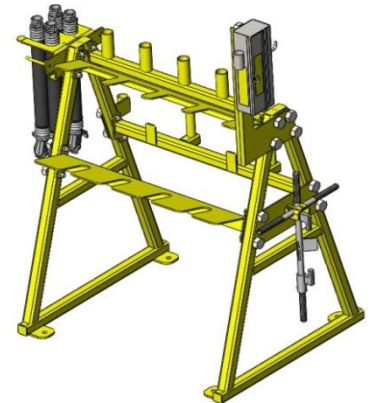
Item # 0316 Fits 4
Unit Rack With
2 Air Outlets



Wabtec EOTD Rack

11 Unit Item # 0350
W98" X D 29" H 52"

7 Unit Item # 0351
W64" X D26"X H52"



Universal EOTD Storage Rack

4 Unit Item # 0459
6 Unit Item # 0459-1



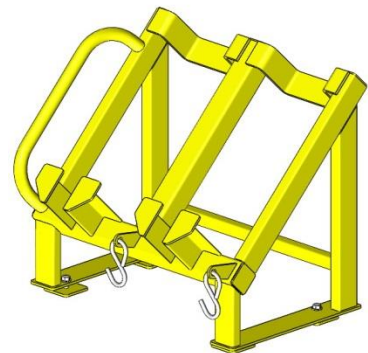
2 Inch Receiver Mounted EOTD Holder

Single Style Item # 0446

Double Style Item # 0446-2



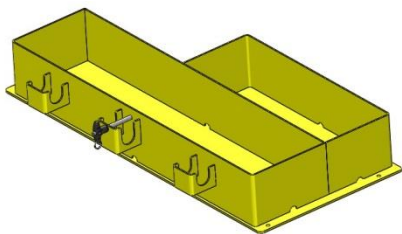
Flat Bed Truck Components



EOTD Truck Bed Storage Fixture

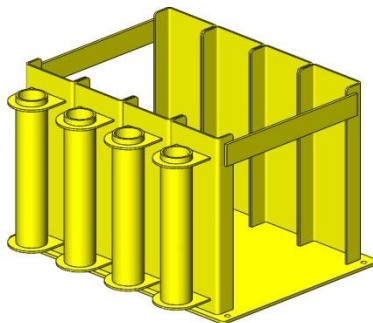
Right Hand Item # 0419-14R

Left Hand Item # 0419-14L



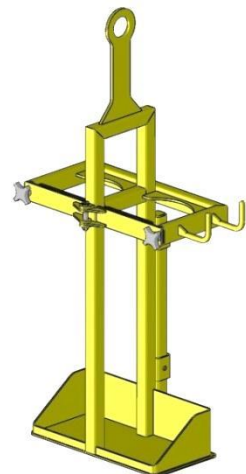
Component Tray

Item # 0419S-11



Steel Brake Shoe Holder

Item # 0419S-3



Lift Off Gas Bottle Holder

Item # 0419-1



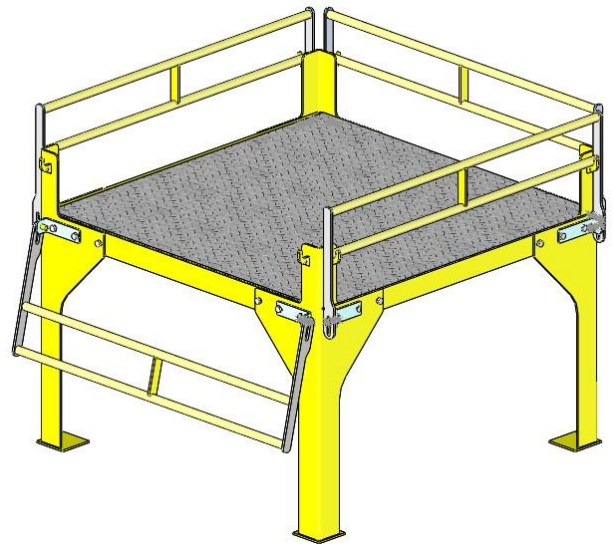
Brake Shoe Table
42" X 52" Item # 0190



Flat Top Table
48" X 48" Item # 0033-1



Air Brake Valve Table
52" X 52" Item # 0202

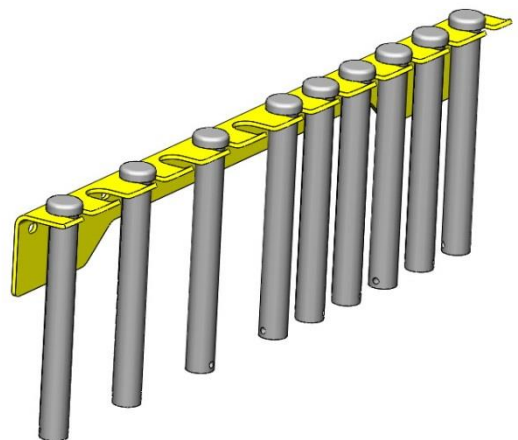


Knuckle Table
48" X 48" Item # 0033-15

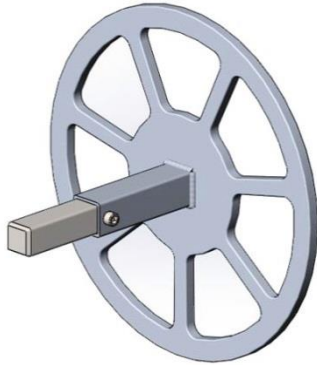


Table Dividers

Table Size	Compartments	Item #
52 X 52	4	0202-4
52 X 52	6	0202-6
52 X 52	8	0202-8
52 X 42	4	0190-4
52 X 42	6	0190-6
52 X 42	8	0190-8



**Optional Knuckle Table
Bolt On Pin Holder**
Item # 0033-2



Aluminum Hopper Outlet
Gate Hand Wheel

Item # 0582



Hopper Gate
Installation Fixture

Item # 0264



Hopper Gate
Outlet Socket

$\frac{3}{4}$ " Drive Item # 0340-2

1" Drive Item # 0340-1



Forklift Lifting Attachment
Capacity 3000 Lbs

Item #	Fork Width
WCWSF3	3"
WCWSF4	4"
WCWSF5	5"
WCWSF6	6"



18 Inch Chain
Extension

Item # WCW SF18E



Red Track Flag Kit
Item # 0097-3



Blue Track Flag Kit
Item # 0097-7



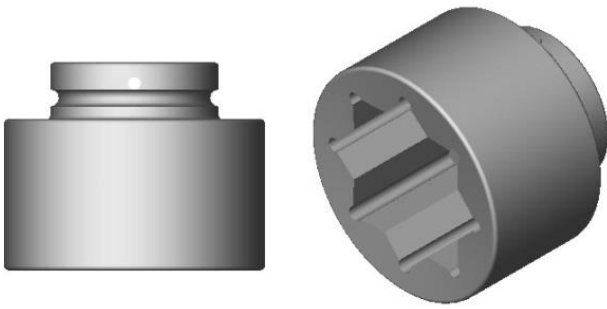
Switch Point Lock
Item # 0160



Padlock Lockout
Item # 0158 / UP Style
Item # 0465 / NS Style

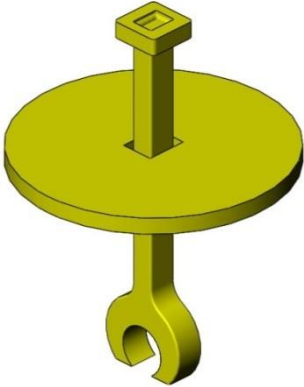


**Multi Craft Switch
Lockout**
Item # 0227
With Lanyard Item # 0227-1



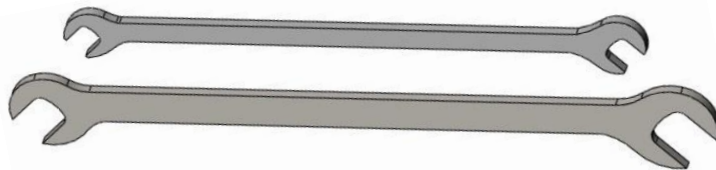
Complete Line of 6 and 8 Point Track & Lag Screw Sockets

3/4 & 1" Drive
3/4" thru 2-3/16"



Switch Point Spike Puller Attachment For Stanley Hydraulic Puller

Item # 0522



Signal Switch Adjustment Wrenches

1-1/16" – 1-1/4" Item WCW3440-45

1-5/8" – 2" Item # WCW5264-45



Dumpster Handle Release Tool

Item # 0245 36" to 60"

Item # 0246 48" to 96"



Eidos Ergonomic Chairs

Batwing

Item # WCW109CT



Weldmaster

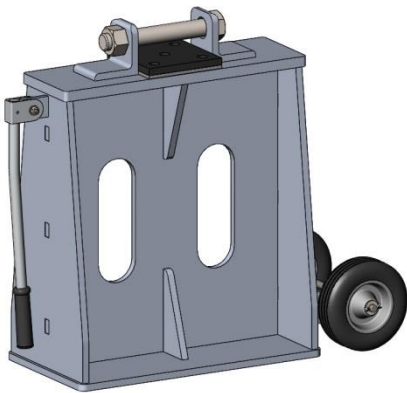
Item # WCW110



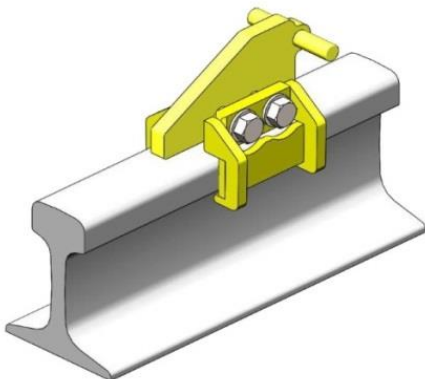
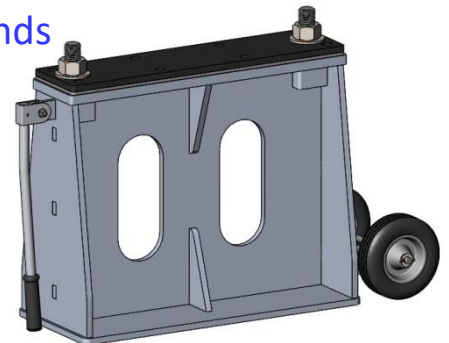
Taskmaster

Item # WCW112

Locomotive



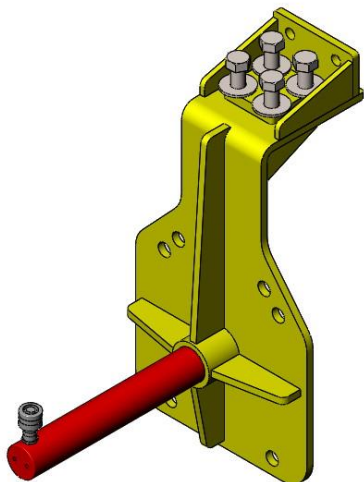
Aluminum EVO Engine Stands
Set of 4
Item # 0528



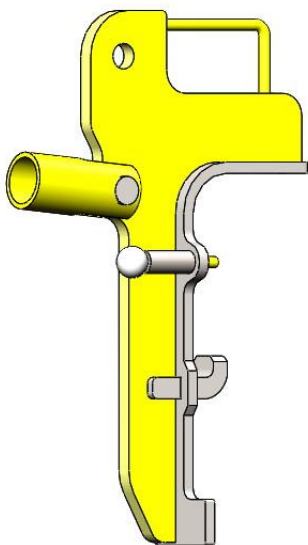
Drop Pit Rail Clamps
Set of 4
Item # 0253-1



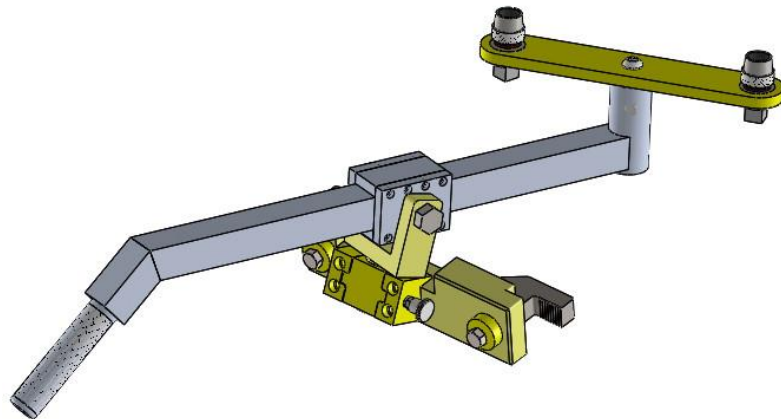
Drop Pit Carriage
Item # Custom Built



SD 70 Journal Box Remover
Item # 0527



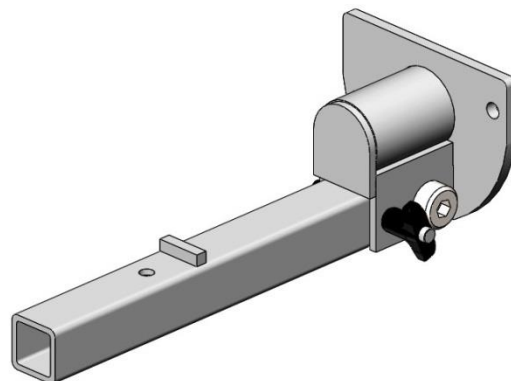
Coupler Lifter
Used With Gieske C –Frame
Item # 0518



Tier 4
Hydraulic Torque Wrench
Extension Arm for
Connecting Rod
(HYTORC AVANTI 1 Not Included)
Item # 0499



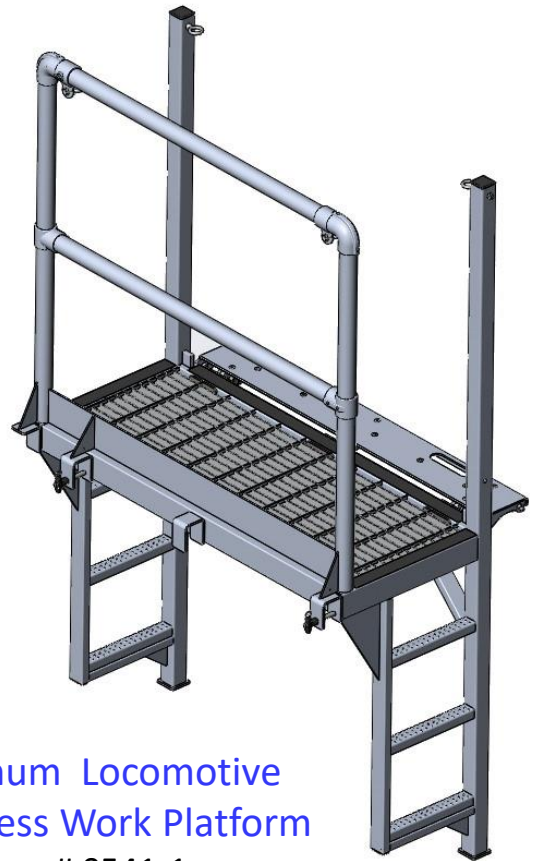
Safe-Set Locomotive
Parking Brake Lifting Fixture
Item # 0373



Graham White Electric Wheel
Handbrake Lifter Used With Gieske
C-Frame
Item # 0525



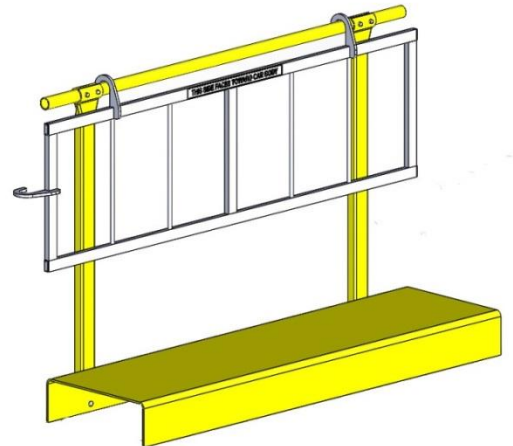
Locomotive Side
Work Platform
Item # 0384



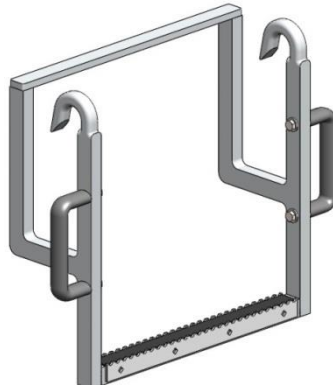
Aluminum Locomotive
Side Access Work Platform
Item # 0541-1

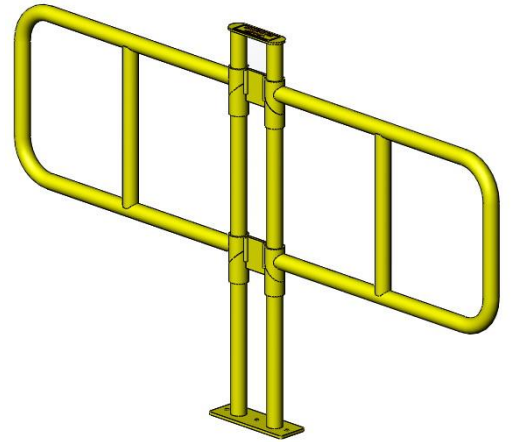


Aluminum Locomotive Step
Item # 0514



Aluminum
Locomotive Handrail
Protection Gate
Item # 0372





Automatic Locomotive
Swing-Away Ramp Gate

Item # 0579



Knife Switch Lockout

Item # 0238



Fuse Blocker

Item # 0211



Locomotive Jump Start
Electrode Pole

Item # 0305



Grid Lifter

DC Item # 0142

AC Item # 0141

Moseback # 0143



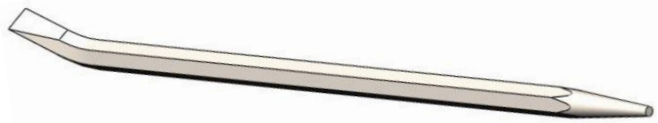
GURU Water Dump
Valve Retention Tool
Item # 0289



Power Assembly
Jewelry Tray
Item # 0254



EMD
Pet Cock Test Socket
Item # WCWN6387A



42" Brake Shoe Bar
Item # WCW40023



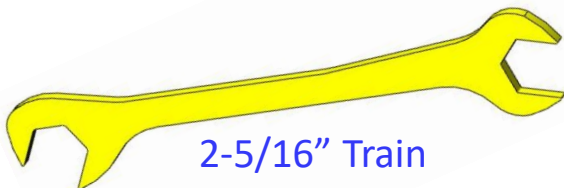
Buggy Bar
Item # 0083



GE Fuel Injector Puller
Item # 0043



Lubricator Pad Channel Scraper
Item # 0494



2-5/16" Train
Line Wrench
Item # 0244



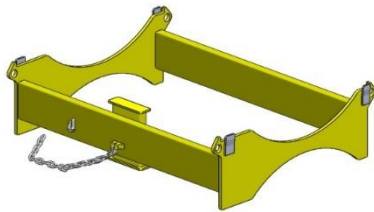
Turbo Charger Spin Pole
Item # 0302



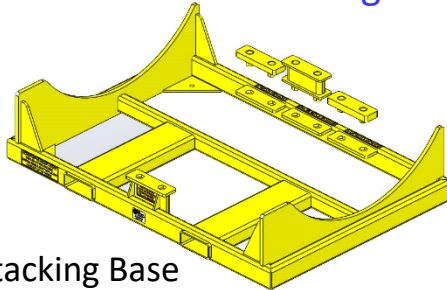
15/16" EMD
Valve Adjustment Wrench
Item 0228



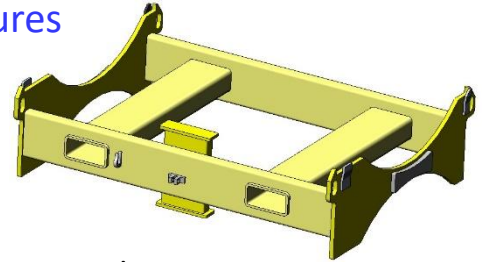
Traction Motor Stacking Fixtures



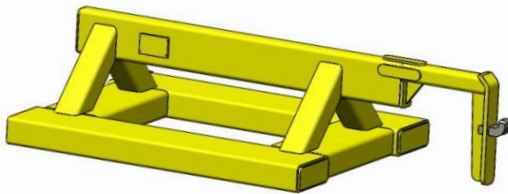
Stacking Fixture
Item # 0032



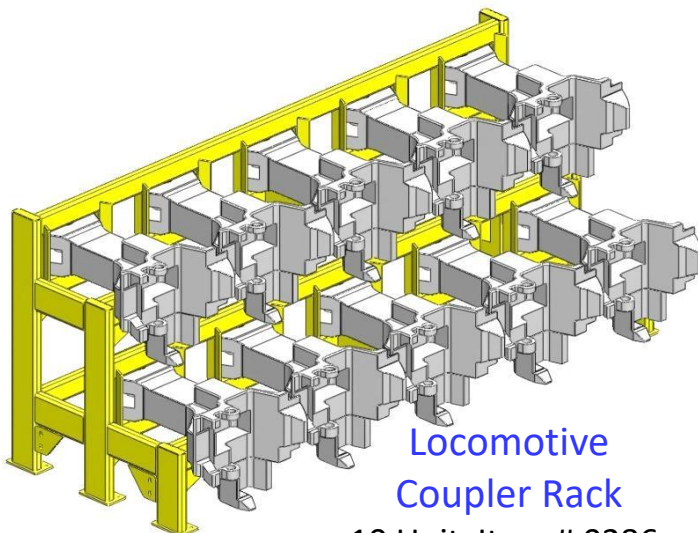
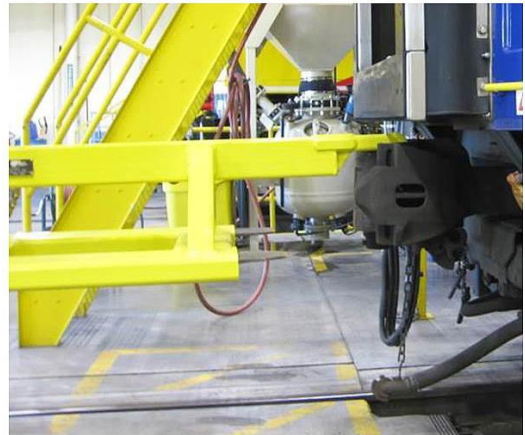
Stacking Base
Item # 0032-2



Stacking Fixture
Item # 0032-4



Locomotive and Passenger Car
Coupler Carrier
Item # 0308-1



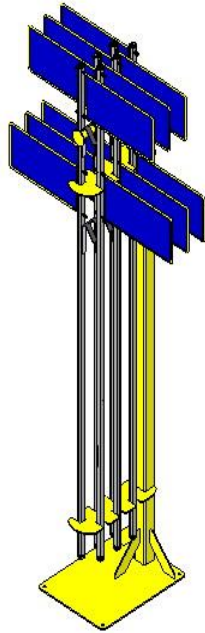
Locomotive
Coupler Rack
10 Unit Item # 0286
6 Unit Item # 0286-6



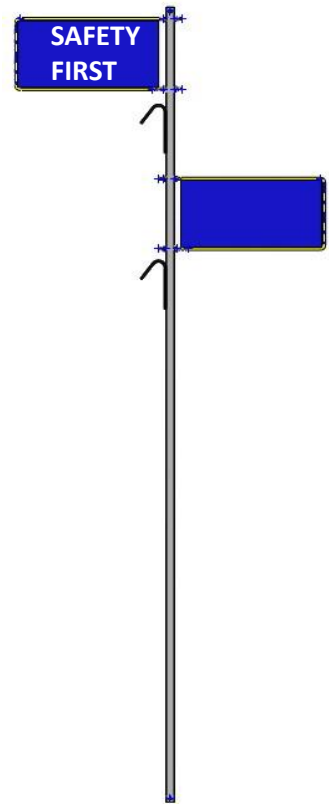
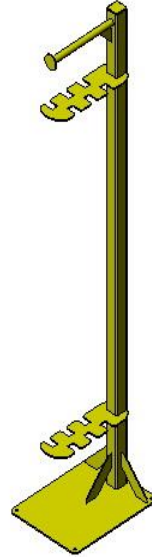
63 unit Locomotive
Air Hose Rack
Item # 0385-1



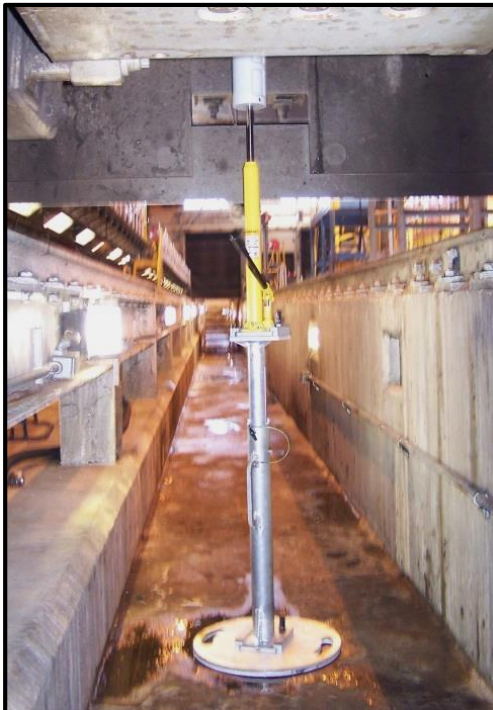
15 Unit Flag Stand
Item # 0381



6 Unit Flag Stand
Item # 0381-1



Locomotive
Blue Safety Flag
Item # 0114
Red Fueling Flag
Item # 0114-5



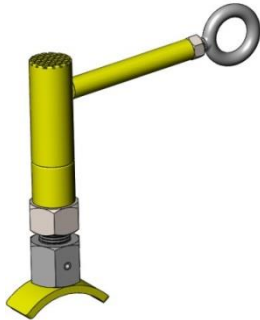
Adjustable Height
Coupler Pin Lifter
Item # 0310



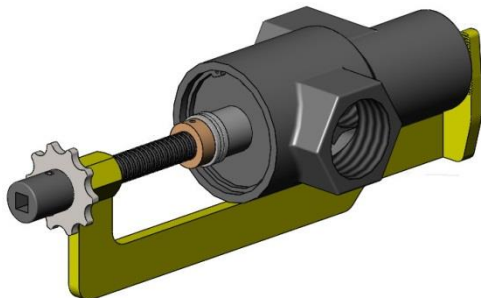
Toilet Servicing Cart
Item # 0632



Locomotive Hand Rail
Section Hangers Set of 2
Item # 0319



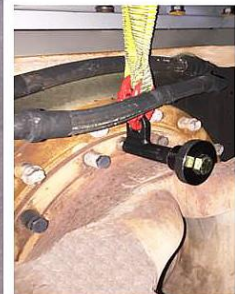
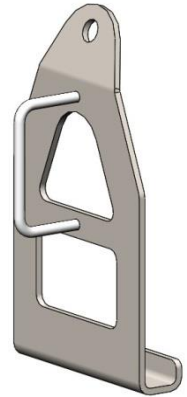
Locomotive ACE Check Valve
Compressor
Item # 0557



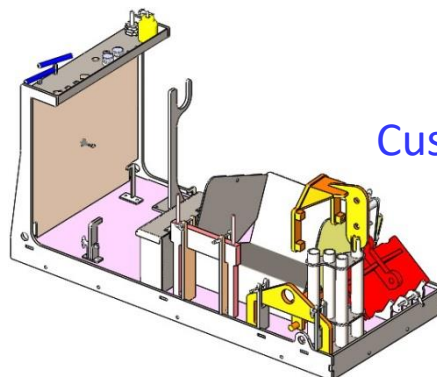
Locomotive ACE Starter Valve
Compressor
Item # 0556



GE Journal Box
Bearing Housing
Lifting Sling
Item # 0551



Transition Section Lifter
Lifts GEVO Stage 1, Stage 2 & FDL
Transition sections.
Item # 0570



Custom Tool Carts



EMD Right Hand Item # 0207
EMD Left Hand Item # 0208
GE Universal Item # 0209

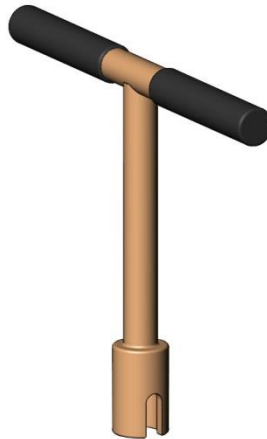


Telescopic Inspection Mirrors

Mirror Size	Handle Size	Item #
4 X 6	8-1/2 To 37	WCW17765
2-1/4 X 3-5/8	7-3/4 To 35-1/2	WCW17750
1-3/4 X 2-1/2	6-1/2 To 27-1/2	WCW17755
3/4 X 2-1/2	6-1/2 To 27-1/2	WCW17760

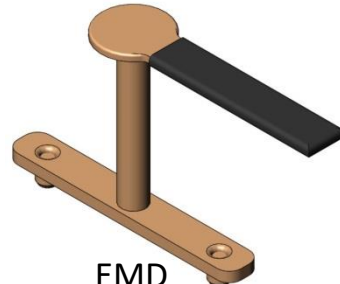


Split Ring Pliers
Item # 0307



GE
Item # 0502

Radiator Cap Removal Tool



EMD
Item # 0503



GE Exhaust Manifold Pliers
Item # 0375

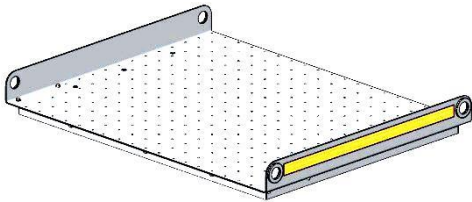


Broken Pipe & Screw Extractor

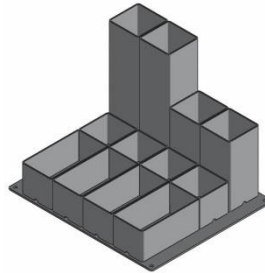
Complete Set Item # 0418
1-1/4" Only Item # 0298

Kubota Model 900 & 1100

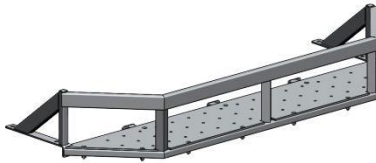
Aluminum Bed and Bolt-On Storage Accessories



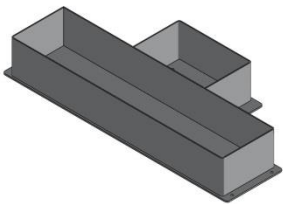
Aluminum Detachable Bed
With Sub-Frame Item # 0419



Square Tube Parts And
Tool Holder Item # 0419-12



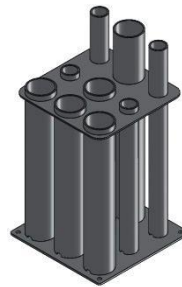
Rear Extension With Deck
And Bumper Item # 0419-2



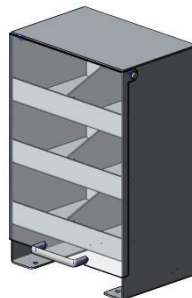
Large Box Parts And
Tool Holder Item # 0419-11



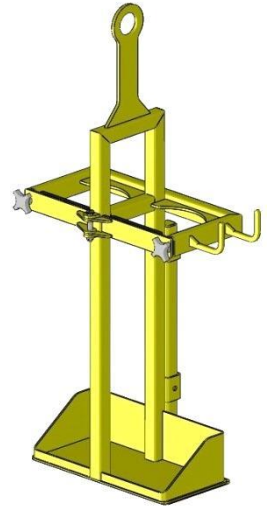
Torch Holder Item # 0419-6



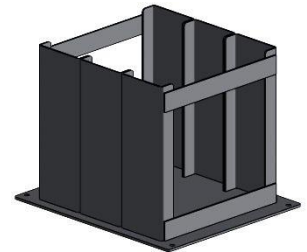
Round Tube Bar And
Tool Holder Item # 0419-4



Small Parts Storage Bin
With Cover Item # 0419-8



Lift Off Gas Bottle Holder
Item # 0419-1



Brake Shoe Storage Bin
Item # 0419-3



Hose Reel Or Air Compressor
Stand Item # 0419-9



Vise Mount W/O Vise
Item # 0419-7



For Complete Product Line and Pricing

WCWRAIL.com