

TOOL AND MACHINERY GUIDE



402-253-2772

WEBSITE: WCWRAIL.COM

Title: Model 304 Coupler Lifting Fixture

Prepared By: Wulf's Custom Welding

Document No: 0405-1

Date: July 7, 2023

SUBJECT: MODEL 304 COUPLER LIFTING FIXTURE

Capacity: This fixture has a rated capacity of 500 pounds.

FIGURE 1

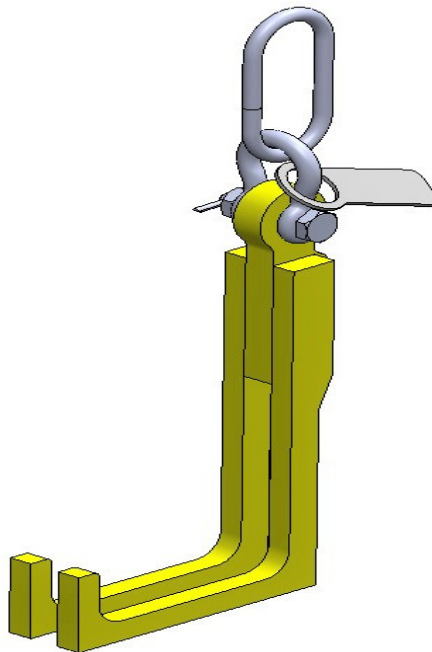

TECHNICAL SPECIFICATIONS:

Available Through:

Wulf's Custom Welding
19102 So. 156th Street
Springfield, NE 68059
Tel: 402-253-2772
Fax: 402-253-9092
Website: wcwrail.com
Reference Part Number: 0405

Fixture Weight: 18 Pounds

Base Construction Material: Grade 50 Steel

DESCRIPTION:

This fixture is designed to lift and transport Model 304 couplers. It has no other intended uses.

INSTRUCTIONS FOR USE:

MODEL 304 COUPLER REMOVAL

WARNING: Ensure car(s) are properly secured with hand brakes and/or chocks before attempting to perform any component repairs.

WARNING: Ensure Blue Flag protection is set in accordance with current operating rules before fouling any track or performing any type of repair work.

1. Inspect the fixture for defects. Look for any signs of fixture deformation or cracked or broken welds. Make sure the lifting tag is installed on the fixture. Remove the fixture from service if any defects are found (Figure 1).



FIGURE 2



FIGURE 3

2. Remove the knuckle and the locking components from the coupler. The knuckle must be removed to use this fixture.
3. Rotate coupler 90 degrees
4. Keeping hands and fingers clear of pinch points, install fixture through the inboard (rear) casting holes to maintain a level position (Figure 2) Install fixture through outboard (front) casting holes to maintain an angled position (Figure 3). Make sure fixture is fully seated in casting holes
5. Remove retainer keys and slowly raise coupler using a crane, hoist, or forklift equipped with approved hook type lifting device
6. Stop lifting as soon as the coupler is free to move within the yoke. Continued lifting could cause severe damage to the lifting device.
7. Remove coupler from car. Keep clear of suspended load

8. Move the coupler to the desired location for disposal or storage and lower it to the ground. Caution must be taken when the coupler is out of the freight car. The coupler could tip over if bumped and strike the user. The coupler should either be rotated 90 degrees coupler clockwise so that it will rest firmly on the ground, or placed into a fixture that will hold it upright while completing repairs

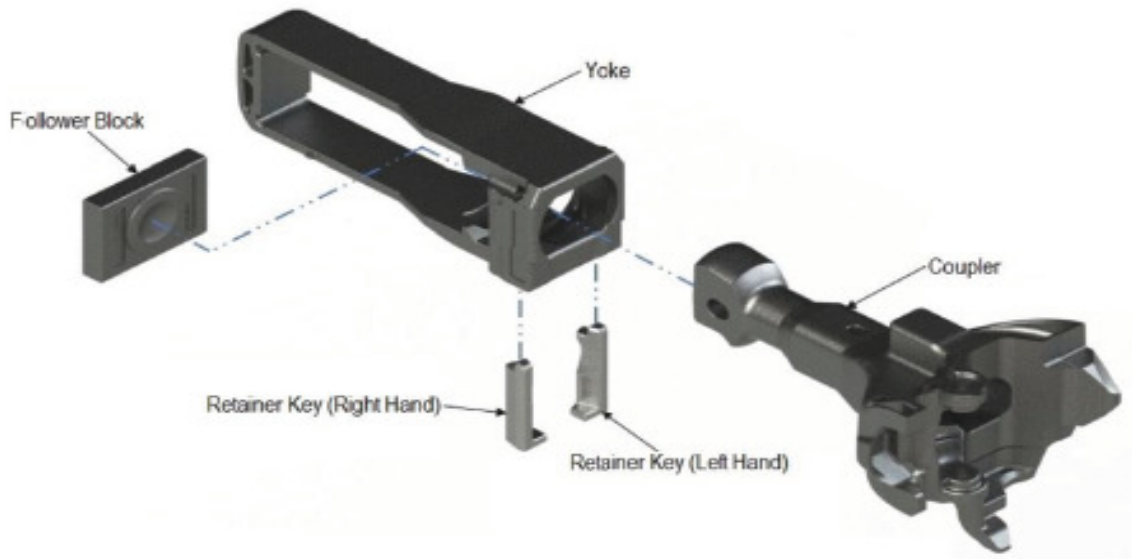

MODEL 304 COUPLER INSTALLATION

1. With coupler laying on floor, insert lifting fixture in casting holes for desired lift (level or angled).
2. Slowly lift coupler from ground allowing to rotate 90 degrees. Keep hands and feet clear from coupler as it rotates to correct position for installation
3. With lifting fixture fully seated in casting holes, lift coupler and install.

SAFETY PRECAUTIONS:

WARNINGS: Noncompliance could cause injury to employees

CAUTIONS: Noncompliance could cause damage to equipment

NOTES: Pertinent information

1. **WARNING:** Wear personal protective equipment in accordance with all current Safety rules and requirements.
2. **WARNING:** Keep hands and fingers away from the lifting fixture when installing or removing it from the coupler casting.
3. **WARNING:** Keep all parts of your body out from under any suspended load.
4. **WARNING:** Do not exceed the rated capacity of the lifting fixture. Never use the fixture for any purpose other than lifting Model 304 couplers.